

Fort Myers Christian School PICK-UP AND DROP-OFF DIRECTIONS

ELEMENTARY

Before School Drop-off:

From 7:00 – 8:00 a.m. drop off for all elementary students will be at the rear of the Children's Center in the cafeteria.

Morning Drop Off

Students are to be dropped off at the Summerlin entrance between 8:00 - 8:15 a.m.

- Cars dropping off students should start with two lines and then merge into one line at the traffic cone on the curved drive in front of the Children's Center. Students should stay in the car until they pull up to the sidewalk.
- Pull up, drop off your student, and then continue on. **NO PASSING!**
- Do not park in the drop off lane and do **NOT** stop for extended time.
- If you want to walk your child to his/her classroom, please park your car in the designated school parking lot area first and obtain a visitor pass from the office.
- If a student arrives after 8:15 am, they must get a tardy pass from the front office.

Afternoon Pick-up: NEW FOR 17-18

- Pick-up will now be located on the **east side** of the Children's Center.
- Parents will enter from the Summerlin entrance (see diagram on the back) drive to the back of the parking lot and then a line will form along the access road that leads to the covered overhang by the Church/Children Chapel.
- We will no longer utilize the walkie-talkie and a teacher walking in line to announce names to the building. ALL cars approaching should have their car sign on their rearview mirror. All students will be seated in lines outside with their class, they will be called up when their car pulls up and the car door will be opened for them to enter the car.
- **Anyone that does not have the proper car sign displayed will be asked to drive to the west side of the building, park, come into the school office and present a photo ID. NO student will be released to anyone who does not appear on the authorized**

pick up list without prior parental approval.

- Please keep your car tag on your rear-view mirror until the student has been placed in your car.
- For **SECURITY REASONS, DO NOT park and walk up to the drop off area. We ask parents to wait patiently inside their vehicle in line.**
- Students will be called over to their car up to 3:00 p.m. Please be patient in the pick-up line.
- Due to safety concerns, we cannot walk your child around to the driver's side back seat. Please be ready for them to board on the passenger side when you pull up to the pick-up area.
- Parents needing to talk to a teacher should make an appointment for after school. Please **DO NOT HOLD UP** the pickup line trying to talk to a teacher.

Any students not picked up by 3:00 p.m. will **AUTOMATICALLY** go to the after-school program.

MIDDLE SCHOOL

Morning Drop Off

From 7:00 – 7:30 a.m. students should be dropped off at the rear of the Children's Center in the cafeteria.

7:30 – 8:00 a.m. - 6th - 8th grade students are to be dropped off at the middle school cafeteria. Students should not be in their classrooms or at their lockers before 8:00 a.m.

- If your student is going to stay with you in your car until 8:00, please park your car rather than sit in the car line.

At 8:00 a.m. students may go directly to their classrooms.

Afternoon Pick-up:

6th - 8th grade students are to be picked up by the courtyard canopy from 3:00 – 3:15 p.m. Any students not picked up by 3:15 p.m. will go to the aftercare program in the Children's Center. Students who do not report, and are not supervised on the school grounds, will receive a detention. Students have to be supervised after 3:20 whether in aftercare or on a sports team.

Fort Myers Christian School Morning Drop Off Map

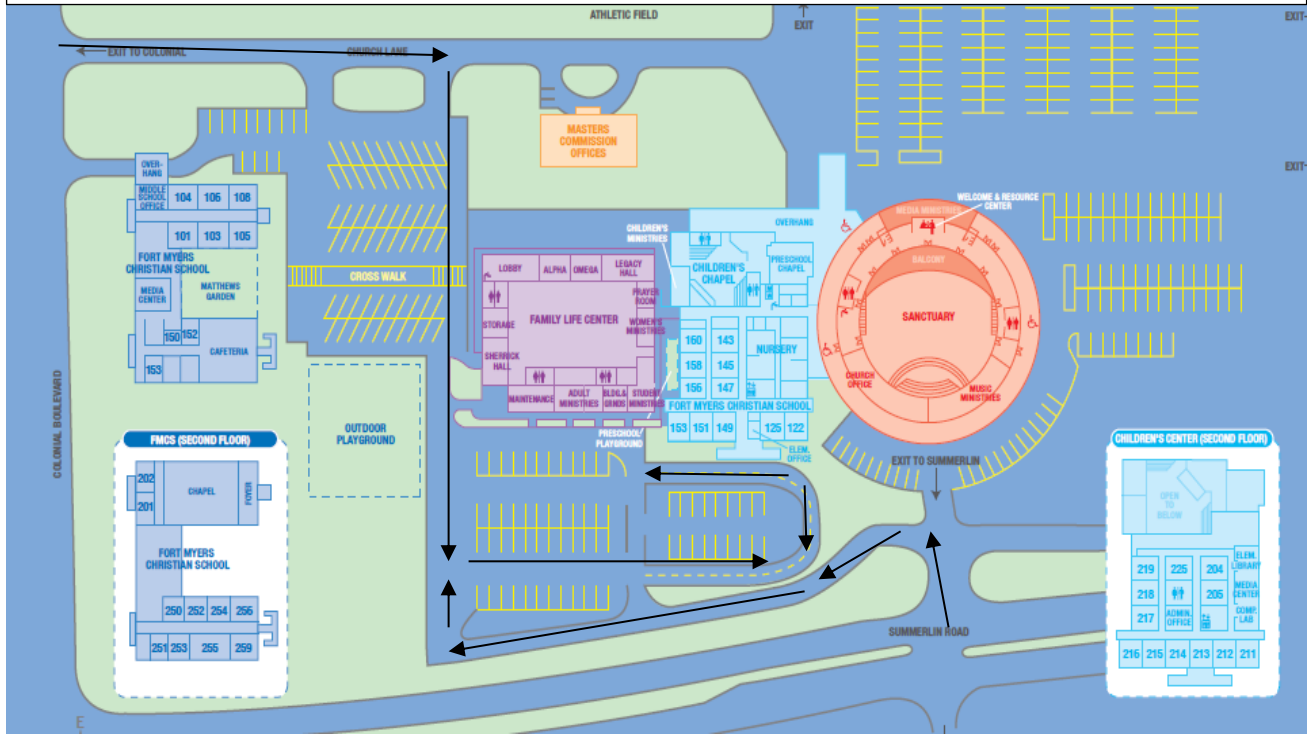

Fort Myers Christian School Afternoon (2:40) - NEW Pick Up Map

